

### Position Monitoring Switchbox



IP67 water-proof  
316LSS



IP67 water-proof  
IP68 (50M @72hrs tested by SGS)  
SIL3 Approval



IP67 / ExdIICT6 Explosion-proof  
316SS



Magnet Type, 2xSPST/NO  
Reed Switch, 0.5A at 250VAC



IP68 (30M @24hrs tested by TUV)  
IP67 & ExdIICT6 Explosion-proof  
SIL3 Approval  
316SS



IP68 (30M @24hrs tested by TUV)  
IP67 & ExdIICT6 Explosion-proof  
SIL3 Approval



IP67 / ExdIICT6 Explosion-proof  
SIL3 Approval

## Water Proof IP68 (TUV 30M / 24hr, SGS 50M / 72hr)

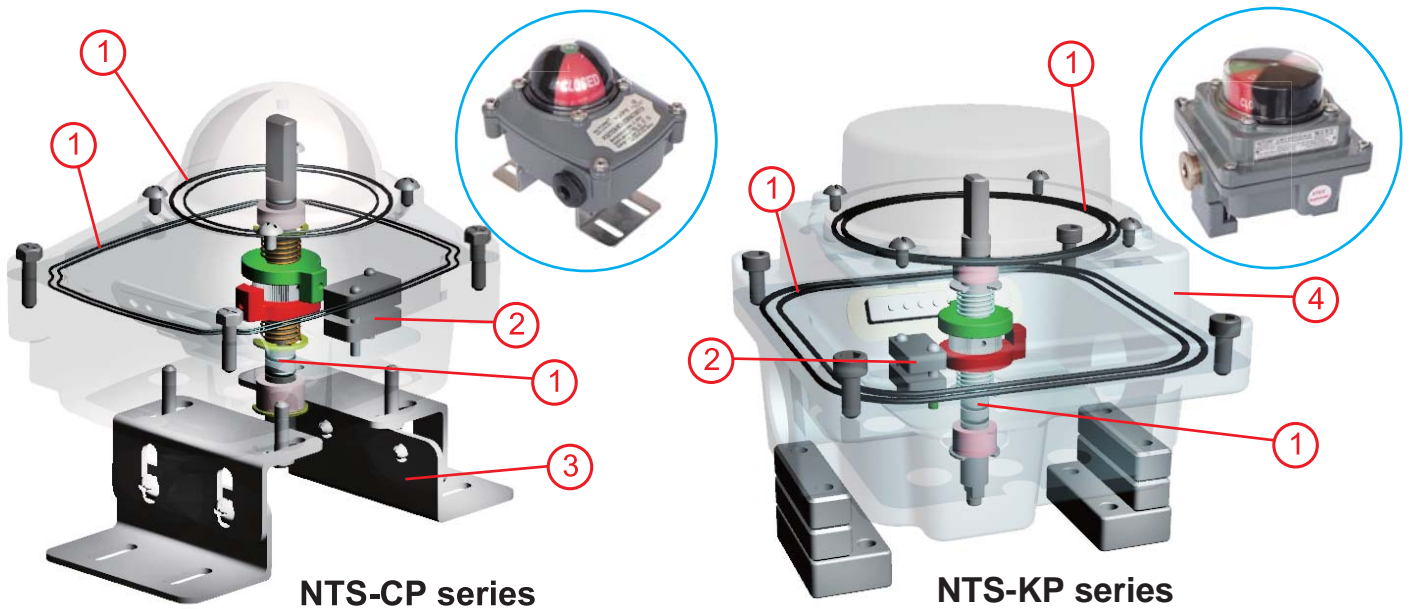

1. Double seal, IP68 design

2. Optional P&F SIL2 proximity switch

3. Stainless Steel universal bracket

4. ATEX EExdIIBT6 explosion-proof



ATEX EExdIIBT6 explosion-proof



TUV 30M / 24hr



SGS 50M / 72hr

## NTS Valve Position Monitor(Limit Switchbox)

### Material of Construction

Aluminum Alloy Body: NTS-C,CS, CP,K,KP,H Series

316SS Body: CS,HS,KS Series



**NTS-C/CP**

IP67 water-proof  
IP68 (50M @72hrs  
tested by SGS)  
SIL3 Approval



**NTS-CS**

IP67 water-proof  
316LSS



**NTS-K/KP**

IP68 (30M @24hrs  
tested by TUV)  
IP67 & ExdIIBT6  
Explosion-proof  
SIL3 Approval



**NTS-KS**

IP68 (30M @24hrs  
tested by TUV)  
IP67 & ExdIIBT6  
Explosion-proof  
SIL3 Approval  
316SS



**NTS-H**

IP67/ExdIICT6  
Ex-proof  
SIL3 Approval



**NTS-HS**



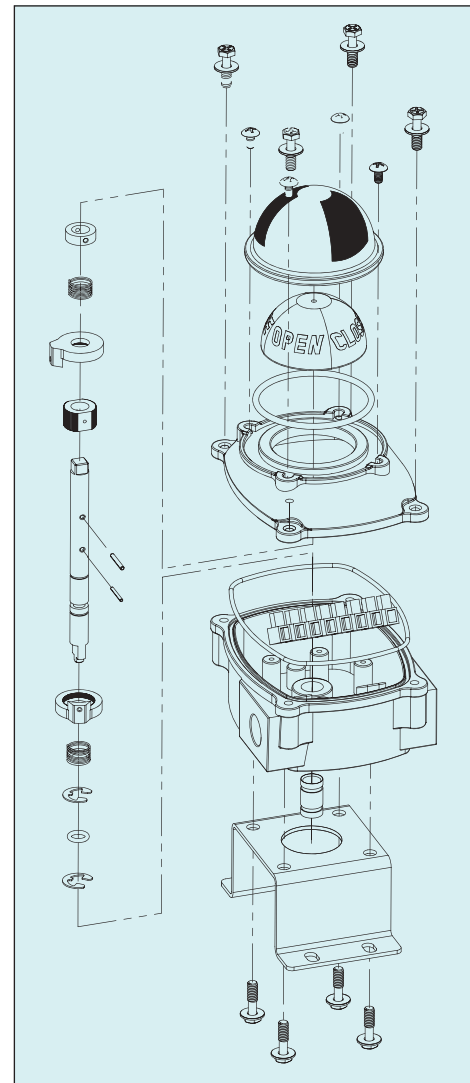

IP67/ExdIICT6  
Ex-proof  
316SS

Housing	Low cooper aluminum die-casting
Coating	Epoxy-Polyester
Sealing	NBR O-rings on each interface (Dome indicator,Lower/Upper Housing, Shaft)
Cams	Poly-Carbonate
Bushings	Bronze
Shaft	AISI304 Stainless Steel
Earth Lug	Stainless Steel
Mounting Bracket	AISI304 Stainless Steel



## NTS Valve Position Monitor (Limit Switchbox)

### NKS-C,CP,CS,K,KP,KS,F,H ,HS, Series General Specification











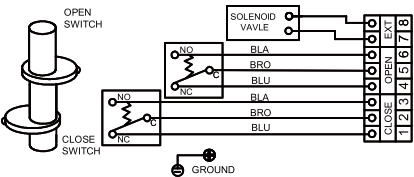

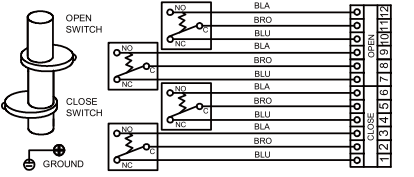

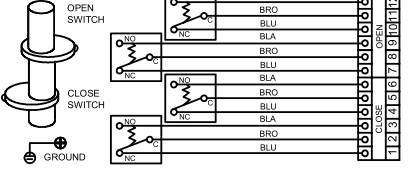
 <p>316LSS</p>	<p><b>NTS-C/CP Series, Weather-Proof, SIL3 Approval</b>  <b>NTS-CS (316LSS) Series, Weatherr-Proof.</b></p> <ul style="list-style-type: none"> <li>- Enclosure: NTS-C/CP Series: Aluminum Die-casting , NTS-CS Series: 316LSS material, Weather proof - IP67/NEMA 4&amp;4X, IP68 water-proof</li> <li>- Bolts on visual position indicator</li> <li>- Switches: 2, 3 or 4xSPDT mechanical switch or proximity</li> <li>- Cable Entry: 2x1/2"NPT(std.) or M20x1.5</li> <li>- Terminal Strip: points(0.08~2.5mm2), Option:8-16 points</li> <li>- Easy mounting, Namur standard, stainless steel bracket &amp; bolts"</li> </ul>
 <p>316SS</p>	<p><b>NTS-H Series, Ex-Proof(ExdIICT6), SIL3 Approval</b>  <b>NTS-HS (316SS) Series, Ex-Proof(ExdIICT6)</b></p> <ul style="list-style-type: none"> <li>- Enclosure: NTS-H Series: Aluminum Die-casting, NTS-HS Series: 316SS material. Weather proof - IP67/NEMA 4&amp;4X, IP68 (Optional) &amp; Explosion proof: EExdIICT6</li> <li>- Bolts on visual position indicator</li> <li>- Switches: 2, 3 or 4xSPDT mechanical switch or proximity</li> <li>- Cable Entry: 2x3/4"NPT(std.) or M20x1.5</li> <li>- Terminal Strip: points(0.08~2.5mm2), Option:8-16 points</li> <li>- Easy mounting, Namur standard, stainless steel bracket &amp; bolts"</li> </ul>
 <p>316SS</p>	<p><b>NTS-K/KP Series, IP67/IP68 Water-proof, ExdIICT6 Ex-proof, SIL3 Approval</b>  <b>NTS-KS (316SS) Series, Ex-Proof(ExdIICT6)</b></p> <ul style="list-style-type: none"> <li>- Enclosure: NTS-K/KP Series: Aluminum Die-casting, NTS-KS Series:316SS material. Weather proof - IP67/IP68 Water-proof, ExdIICT6 Ex-proof</li> <li>- Bolts on visual position Indicator</li> <li>- Switches: 2, 3 or 4 x SPDT mechanical switch or proximity</li> <li>- Cable Entry: 2 x 3/4"NPT(std.). Option:M20,PG13.5,PF1/2",PT1/2"</li> <li>- Terminal Strip: 8 points(0.08 – 2.5mm2), Option: 8-16 points</li> <li>- Easy mounting, Namur standard, stainless steel bracket &amp; bolts</li> </ul>
	<p><b>NTS-F Series, Weather-Proof</b></p> <ul style="list-style-type: none"> <li>- Enclosure: ABS plastic, weather-proof, IP67/NEMA 4 &amp;4X</li> <li>- Visual position Indicator</li> <li>- Switches: 2 x SPST magnet reed switch, LED indicator</li> <li>- 0.7 meter lead wire(std.), option: quick coupler</li> <li>- Easy mounting, Namur Standard, stainless steel bracket &amp; bolts</li> </ul>

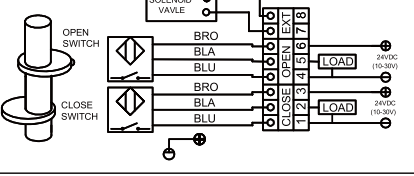
Note: A. Standard Specification: 1. Captive cover bolts. 2. Polyester powder coating (black color).  
 3. Ambient Temp.: -20 ~ +80°C  
 B. The other painting & colors are available upon request`

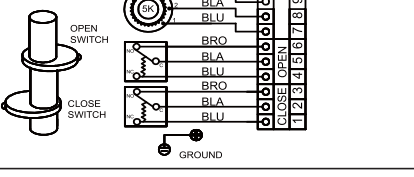

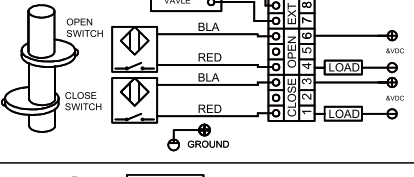
## NTS Valve Position Monitor (Limit Switchbox)

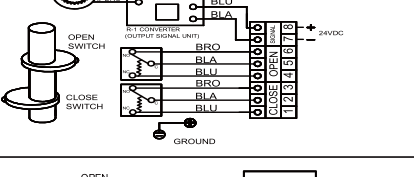
### Switches, Wiring and Bracket(NTS-C,CP,CS,K, KP,KS,H,HS)

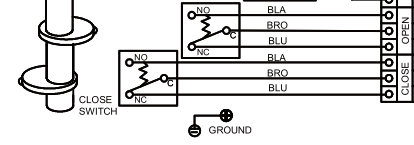
<p><b>2-SPDT mechanical switches</b>                      Rating: 16A@125/250VAC,                      0.6A@125VDC, 0.3A@250VDC                      3A@24VDC                      approved by UL, CSA</p>		
<p><b>4-SPDT mechanical switches</b>                      Rating: 16A@125/250VAC,                      0.6A@125VDC, 0.3A@250VDC                      3A@24VDC                      approved by UL, CSA</p>		
<p><b>2-DPDT mechanical switches</b>                      Rating : 10A 125 or 250VAC                      2A 480VAC                      1/8HP 125VAC, 0.25HP 250VAC                      0.5A 125VDC, 0.25A 250VDC                      approved by UL, CSA</p>		
<p><b>Autonics proximity sensors PS17-5DNU(NPN, PNP), 3-wire</b>                      Voltage rating : 10~30VDC                      Sensing distance : 5mm                      Ambient temperature : -25~+70°C</p>		
<p><b>P &amp; F proximity sensors NJ2-V3-N(Intrinsic safe, 2-wire)</b>                      Voltage rating : 8.2 V DC                      Sensing distance : 2mm                      Ambient temperature : -25~+100°C</p>		
<p><b>Potentiometer</b>                      Providing 0-1K ohm output signal,                      Options: 0-5K or 10K ohm</p>		
<p><b>Position Transmitter</b>                      Providing 4-20mA DC(or 0~1K ohm)                      output signal as feedback, 15~28VDC                      loop power(24V DC input power)                      Load impedance : 0~600 Ohm,                      Max output : 35mA DC                      Adjustment : Zero and span</p>		
<p><b>Magnet type reed switch</b>                      Hermetically sealed,2xSPDT or DPDT                      Rating:3A@5-240VAC/DC                      Sensing distance: 5mm                      Ambient temperature : -40~+125°C                      EExialICT6 &amp; EExdiICT6 approved</p>		

## NTS Valve Position Monitor (Limit Switchbox)

### Dimension

NTS-C/CP Series

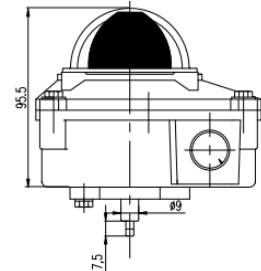
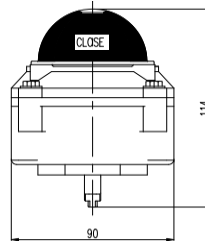
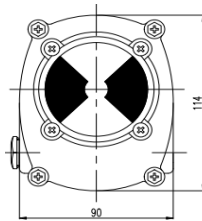

NTS-CS Series

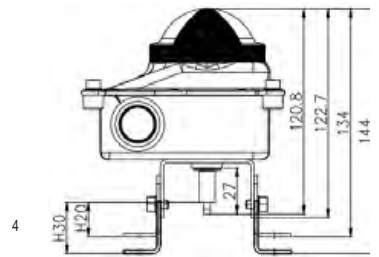
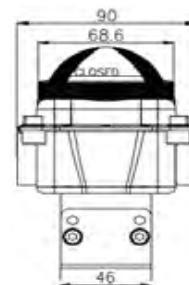
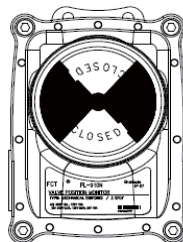

NTS-H/HS Series

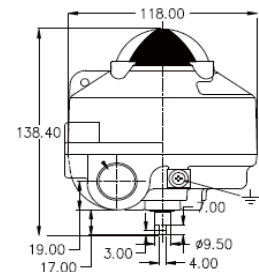
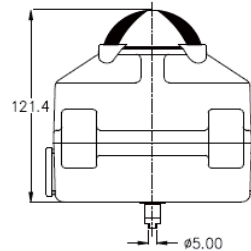
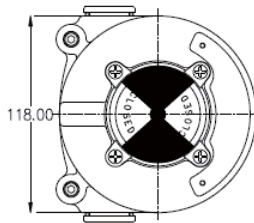

NTS-K/KP/KS Series

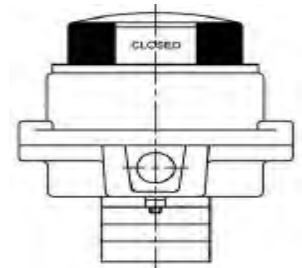
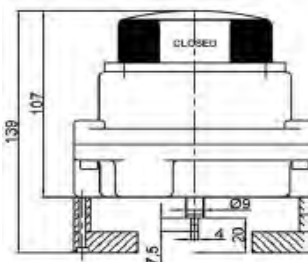
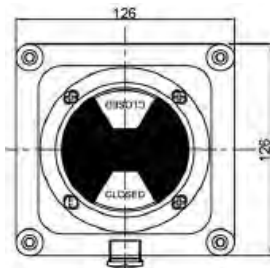
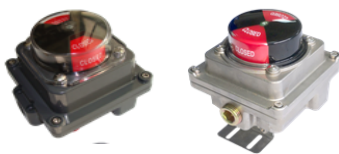

NTS-F Series

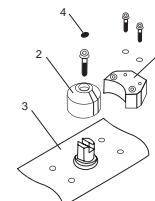
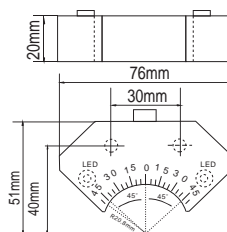

## NTS Valve Position Monitor (Limit Switchbox)

### Ordering Information:

NTS - C - 10 - S1

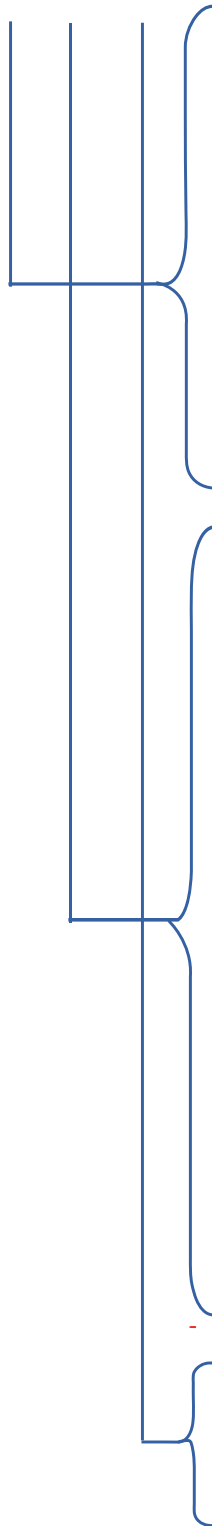

#### Enclosure Type:

C series(Aluminum Die-Casting Housing,IP67/Weather-Proof)

CP series(Aluminum Die-Casting Housing, **IP68/Weather-Proof** )

**Submerged 50Meter@72hrs approved by SGS**

CS series(**316LSS** Housing,IP67/Weather-Proof)

H series(Aluminum Die-Casting Housing,IP67/ExdIICT6)

HS series(**316SS** Housing,IP67/ExdIICT6 )

K series(Aluminum Die-Casting Housing,IP67/ExdIIIBT6 )

KP series(Aluminum Die-Casting Housing, **IP68/ExdIIIBT6** )

**Submerged 30Meter@24hrs approved by TUV**

KS series(**316SS** Housing,IP67/ExdIIIBT6)

F series(ABS Housing,IP65/Weather-Proof)

Note: KS,H,HS,H & K series switchboxes are approved by CE-ATEX

#### Switch Type

Mechanical Switch:

10 - 2xSPDT,mechanical type,16A at 125/250VAC; 0.6A at 125VDC

12 - 4xSPDT,mechanical type,16A at 125/250VAC; 0.6A at 125VDC

13 - 2xDPDT,mechanical type,16A at 125/250VAC; 0.6A at 125VDC

14 - 2xSPDT+Potentiometer(0-5K/10K ohm)

15 - 2xSPDT+Position Transmitter(4-20mADC output)

**Note: NTS-C/CP series is not available at switch type 14 & 15**

**Note: NTS-CS series is not available at 12 ~ 15**

Inductive / Magnet Type Proximity Sensor

21 - P&F NJ2-V3-N (2 wire/NC,8.2VDC,ExialICT6 Ga, IP67, SIL2 approval)

22 - P&F NCB2-V3-N0 (2 wire/NC,8.2VDC,ExialICT6 Ga,IP67,SIL2 approval)

23 - P&F NBN5-F7-E2(3-wire,PNP/NO,IP67 , (10~30 VDC)

24 - Autonics PSN17-5DNU/DPU(3-wire/NPN or PNP,IP67)

25 - Nutork Magnet Type Reed Switch, 2xSPST/NO (2-wire, 5-2 40VAC/DC, ≤ 500m A)

26 - Nutork Magnet Type Reed Switch

2xSPDT(3A @ 5-240VAC/DC,EEExialICT6, SIL3 Approval)

27 - Nutork Magnet Type Reed Switch

2xDPDT(3A @ 5-240VAC/DC,EEExialICT6, SIL3 Approval)

**Note: NTS-C/CP series is not available at 26 & 27**

**NTS-CS series is not available at 24 ~27**

#### Bracket Material

Blank - S.S. Universal Bracket(Standard) for all Namur Dimension

S1 : 80x30x20 Namur S.S. Bracket

S2 :130x30x30 Namur S.S. Bracket

**Note: The price is included 304SS bracket as the standard for all switchbox**

**NUTORK CORP.** manufactures a wide range of pneumatic actuators, electric actuators and the accessories of pneumatic actuator (limit switchbox, solenoid valve, manual override ---etc.) for quarter turn valves

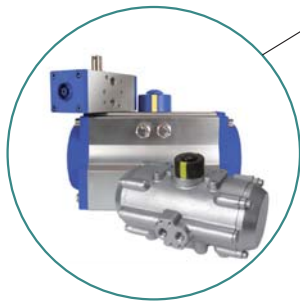

Rack & Pinion Type Pneumatic Actuator.  
**(Certificated by CE-ATEX/SIL3)**  
**Max. Output Torque: 9340Nm**



Scotch Yoke Type Pneumatic & Hydraulic Actuator.  
**(Certificated by CE-ATEX/SIL3)**  
**Max. Output Torque 293800Nm**



NTQ Series Electric Actuator  
IP67/IP68(30M@24hrs)Enclosure & EExdIIBT6Max. Output Torque 6000Nm  
Approved by SIL3/IP68/MD/LVD/EMC.



NTE Series Electric Actuator  
IP67/IP68(30M@24hrs)  
EnclosureMax. Output Torque 6000Nm  
Approved by SIL3/IP68/MD/LVD/EMC.



Limit Switchbox IP67/IP68(50M@72hrs)  
Enclosure & EExdIIBT6/EEExdIICT6



Solenoid Valve 3/2NC & 5/2 Way, Static O-ring Sealing Design.  
Aluminum & 316SS Body  
IP67 & EExdIIBT6/EEExdIICT6



Air Filter Regulator Aluminum Body with Vinyl Paint & 316SS Body.  
Size: 1/4" ~ 1"



Manual Override Aluminum & Cast Iron & Ductile Iron Body  
Max Output Torque 70000Nm



Ball valve (Floating ball design),  
We can provide different pressure rating/  
connection type/ operation mode.



Concentric Soft Seated Butterfly Valve  
High Performance Double Eccentric Butterfly Valve  
High Performance Triple Offset Metal Seated Butterfly Valve  
We can provide different pressure rating/ connection type/ operation mode.